

Let's get
started

Y-cam Protect System Overview

Hub

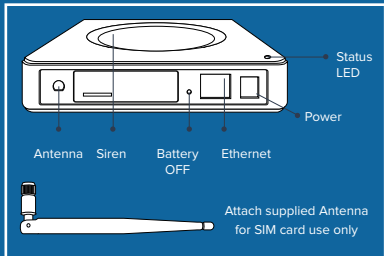

Motion Sensor

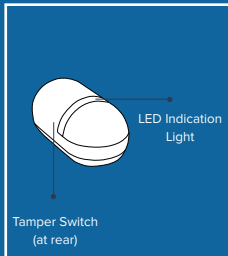

Access Sensor

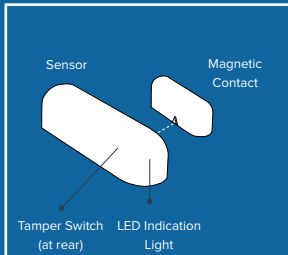

Remote

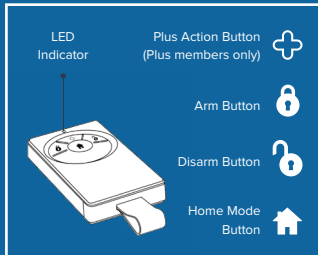

Y-cam Protect Hub Set up



- 1 Download the Y-cam app (📱) on your smartphone (search for “**Y-cam**” on Google Play or the iOS App Store) then follow the steps below.

If you're having problems finding the app please scan the QR code below with your smartphone.



- 2 'Log In' to your Y-cam account to add your Y-cam Protect Hub. If you do not have an account, select 'Sign Up' to create one.
- 3 Existing users select Protect from the side bar menu. New users select Y-cam Protect Hub from the Device selection menu.
- 4 Decide how you would like to use the Y-cam Protect system, you have three options:
 - Internet with SIM Card Back up - Recommended (Plus Service required)
 - SIM Card Only (Plus Service required)
 - Internet only
- 5 Follow on-screen instructions to complete Hub set up.

Add Devices

Once your hub is set up you will be taken to your Protect home screen.

To add a device press the Add (+) button in the top right hand corner and select Add Device.

Follow the on-screen instructions to add your device. Repeat as necessary for each device you would like to add. You can add sensors in any order.

Once all devices have been added please check the Protect Hub settings page, accessible via the side bar menu (☰), to ensure all devices are listed and displayed correctly.

Place each of the devices in the appropriate locations using the guidance enclosed in the following pages.

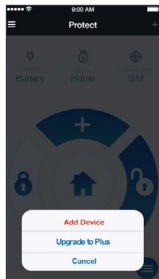
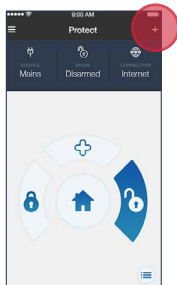

Access Sensor Placement

- To activate your Access Sensor, pull out the battery tab on the back of the sensor.
- Choose your location. Ensure the sensor and magnetic contact are positioned in the correct direction with the arrow indicators facing each other (fig 1). It is recommended to place the sensor on the fixed surface and the smaller magnetic contact on the moving surface.
- Position the sensor and magnetic contact as close to each other as possible. For optimum performance please ensure the gap is no more than 10mm. The maximum supported gap is 20mm (fig 2). To confirm that the sensor is working, separate the contacts and the red LED will start flashing.
- There are two ways to attach the sensor to the wall:
 1. Adhesive mounting: Attach double sided adhesive pad to the back of the Access Sensor (adhesive pad is located in the accessory box in the packaging). Once attached, remove the tape backing sleeve and press and hold firmly against the wall for 15 seconds.
 2. Screw mounting: Open the Access Sensor using the release catch located on top of the sensor. Using an appropriate drill bit, drill through the hole guides located on the top and bottom of the sensor back plate. Attach the sensor to wall using appropriate screws and wall plugs. Close Access Sensor carefully.

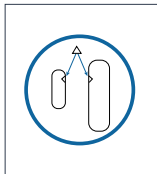

Fig - 1

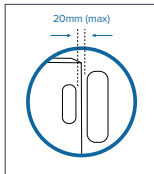

Fig - 2

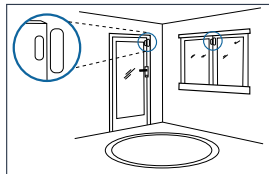
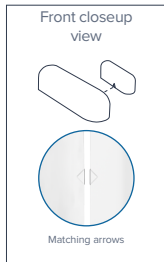
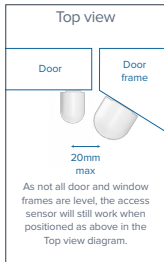
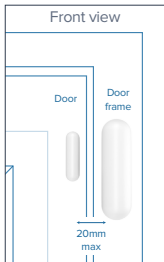

Fig - 3

Access Sensor - How it works

The two parts of the Access Sensor do not have to be aligned horizontally, so they can be attached to angled doors and window frames (see top view diagram). When you need to change the battery, you can leave the backing plate fixed to the surface and release the catch. When installing the Access Sensor please ensure that the arrows on the side of the two parts are facing each other as shown in the diagram.



Installation Tips:

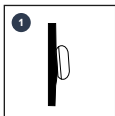

Position on a flat stable surface



Do not install near other wireless devices



Adhesive tape may damage surface when removed

Motion Sensor Placement

- To activate your Motion Sensor, pull out the battery tab on the back of the sensor.
- Choose your location. For best coverage place the sensor 2.3m above floor level on a flat surface. With no obstructions the sensor can detect motion up to 12m at a 90° angle at room temperature (25°C).
- Please make sure your Motion Sensor is installed the correct way up as indicated by the arrow on the rear of the sensor and the diagram below.
- There are two ways to attach the sensor to the wall:
 1. Adhesive mounting: Attach double sided adhesive pad to the back of the Motion Sensor (adhesive pad is located in the accessory box). Once attached, remove the tape backing sleeve and press and hold firmly against the wall for 15 seconds.
 2. Screw mounting: Open the Motion Sensor using the release catch located on top of the sensor. Using an appropriate drill bit, drill through the hole guides located on the top and bottom of the sensor back plate. Attach Sensor to wall using appropriate screws and wall plugs. Close Motion Sensor carefully as directed in the inside cover of the sensor.

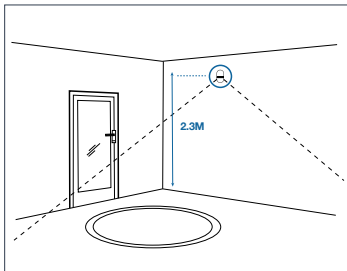

Motion Sensor - How it works

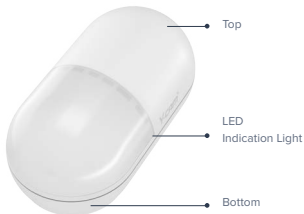

The Motion Sensor will trigger the alarm and send a notification to your compatible smartphone as soon as it detects motion. To ensure you do not receive multiple notifications for the same event the sensor will stop detecting motion for the next five minutes. During this period the LED indication light will not flash. This design feature also means the battery life of the sensor is considerably extended, so you don't have to replace the batteries as often.

When you do need to change the sensor's batteries, you can leave the backing plate fixed to the surface and release the catch from the top.

Installation Tips:

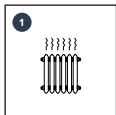

Do not place near heating/cooling equipment

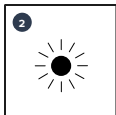

Prevent direct sunlight from reaching the sensor

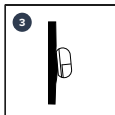

Position on a flat stable surface



Avoid facing metal wall



Adhesive tape may damage surface when removed



TIP:

Avoid pointing outside. Be aware pets can trigger the sensor.

App Home Screens

Homescreen

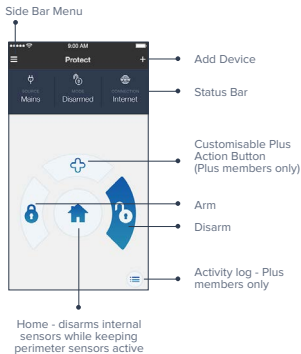

Side Bar Menu

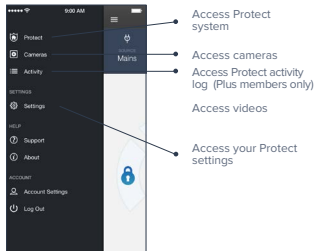

App Screens

Protect Settings

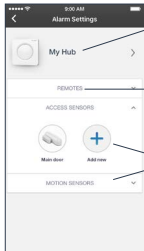

Access Hub settings

Access Remote settings

Access Sensor settings

Protect Activity Log (Plus members only)

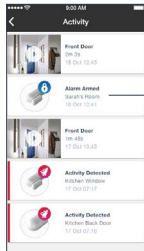

Detailed Activity Log for all Sensors, Remotes, Cameras from the last 30 days



TIP:

Now you can test that the system. Press the Home Button, once armed separate the access sensor and contact. The alarm will trigger and the siren will sound. Press the Disarm Button.

Need support?

Your Y-cam product is designed to be up and running in minutes. Please contact us for assistance or support.

Visit www.y-cam.com or phone us:



+44 (0)20 8334 7373



+1 727 474 1068



**ADD THE
Y-CAM PLUS
SERVICE**

WANT THESE
GREAT FEATURES?

- PHONE CALL ALERTS
- 24/7 LINE MONITORING
- PLUS ACTION BUTTON
- 30 DAY ACTIVITY LOG
 - SIM BACKUP
 - SMS ALERTS

Hardware Limited Warranty

Y-cam Solutions Ltd warrants to the original purchaser, with this limited hardware warranty, that the enclosed Y-cam Protect Home Security System, will be free from defects in material, workmanship and design for 12 months (1 year) from the date of purchase.

This warranty does not cover any damage attributable to normal wear and tear, deterioration, faulty maintenance, erroneous installation or faulty repair. This warranty does not cover damage caused by wilful or accidental mishandling, improper installation or environmental conditions. This warranty is void if the product is tampered with or altered in any way.

Except for the exclusive remedy set forth above, in no event shall Y-cam Solutions Ltd have any liability to the purchaser or any third party for any claim, loss or damage of any kind. In no event shall Y-cam Solutions Ltd's liability for damages, whether arising out of contract, negligence, warranty or infringement of any intellectual property right, exceed the purchase price paid by purchaser for the products.

Y-cam Solutions Ltd specifically disclaims any liability whatsoever for loss of data or loss of information caused by the product. This warranty does not cover Y-cam Solutions Ltd's products if purchased from an unauthorized auction house.

Recycling and disposal

www.y-cam.com/recycle

Dispose in accordance with applicable legislation. The WEEE symbol means that your Y-cam must be disposed of separately from general household waste. When the Y-cam reaches its end of life, take it to a designated waste collection point in your area for safe disposal or recycling.

EU Declaration of Conformity

Y-cam Solutions Ltd hereby declares that this device is in compliance with the essential requirements and other relevant provisions of RTTE Directive 1999/5/EC. A copy of the EU Declaration of Conformity is available at www.y-cam.com/eu-declarations

© 2017 Y-cam Limited. All rights reserved.

All trade names are registered trademarks of respective manufacturers listed. App Store is a service mark of Apple Inc. Android and the "Google Play" logo are trademarks of Google Inc. Phone not included.

This device is restricted to indoor use only.



Created by Y-cam. Made in China.